



# OUR MISSION

## 最优质的包材 最优质的服务

我们的目标是生产最优质的化妆品包材，为全球客户提供最优质的服务。

To offer plastics packing with superior quality and service for the customers all over the world.

我们要成为世界上最具竞争力的高品质塑料包装产品生产商。

Be the best in the world at manufacturing of high quality plastics packaging products at most competitive costs.

我们要建设一个持久的业务平台，把客户、员工、股东连成一个整体。

We are aiming at building an everlasting business platform, joining the customers, the staff and the shareholders together as a whole.







# 1

## WHO WE ARE 我们是谁

我们为美丽时尚事业做包装  
We do packaging for the beauty  
and fashion business

莱汇塑料包装生产化妆品塑料包装容器，如口红、粉盒、唇彩等化妆品包装系列产品。强大迅速高效的生产能力为全球客户提供全面的服务。

NICE PACKAGING CO.,LTD. is devoted to providing plastic cosmetic containers, such as lipstick cases, compacts, lip gloss cases etc. With its powerful, quick and high-efficient production capability, NICE is able to offer comprehensive services to customers from all over the world.





# 2

## DEVELOPMENT

### 企划与开发

根据市场需要严格开发  
多道设计工序  
为客户提供多样  
时尚 实用 精致的包装

我们深知彩妆容器对客户产品品牌形象的重要性,所以我们始终与客户保持一致。我们高度重视产品质量,无论设计、生产、检验与创新,都严格基于市场与客户要求出发。我们总是可以在短时间内实现客户要求,生产出一批高质量的彩妆包装产品。

We are well aware of the importance of cosmetic containers in customer's product brand and image. That's why we always keep pace with our customers. We attach great importance to product quality. Products are designed, produced, inspected and innovated according to the market and customers' requirements. NICE always can provide products with superior quality to customers as required.

莱汇产品注重整体时尚性,无论从容器本身的外观到使用功能,每个细节严格把关,每个角度精心设计,体现非凡的品质。

Our products focus on the overall fashion. From the appearance of the container to the usage and function, we strictly control every detail. Every angle is elaborately designed, which embodies the extraordinary quality.



莱汇塑料包装有限公司, 总部设在香港, 并在广州成立工厂生产。配合不同地区的客户以提供服务, 满足不同的要求。莱汇在国际社会的影响下不断成长, 以谦逊勤勉的态度服务全球客户。NICE PACKAGING LIMITED, Headquartered in Hong Kong and with manufacturing operations in Guangzhou, NICE serves its customers throughout the region and beyond. NICE is growing up in the influence of the international community, serving the global customers modestly and diligently.

作为一个全球性公民, 莱汇尊重人权, 对客户的知识产权持有高度责任感, 负责产品的安全和品牌保护。莱汇荣获ISO900:2008认证并拥有无尘的生产车间。确保每件产品都安全、完整的交给客户, 以客户放心。

As a global citizen, NICE respects human rights, holds high sense of responsibility in protecting customers' intellectual property rights, Responsible for product safety and brand protection. NICE is awarded ISO 9001:2008 accreditations and have dust-free production workshop to ensure we can provide the safe and complete products to our customers.

莱汇公司拥有经验丰富的生产团队。我们的多语言销售团队使我们能提供一个客服对应一位客户的专案跟进、接触及解答, 以满足客户的及时需求和不同的文化要求。

We have a production team with a wealth of experience. Our sales team who are capable of speaking several languages help to provide one-on-one customer services, following up customers' cases, keeping in contact with them and answering their questions. In this way, we can meet the requirements of customers of different culture timely.





# 3

## SERVICES

### 技术服务

先进的成型与工艺技术  
打造更华丽精致的产品  
配合设计和系列的整合  
让产品外观与质量再上一个台阶

Advancing injection and processing technology  
help to create more luxuriant and delicate product.  
Plus overall design and series,  
our product appearance and quality reach a higher level.



# D

## 产品设计及绘图 Product design and drawing

产品设计：根据客人提供的样品的外形、尺寸和功能要求设计出产品  
绘图流程：3D报价图→细节结构功能3D图→工程图→模具图  
Product design: design product with reference to the appearance, size and function of sample provided by the customer  
Drawing process: 3D drawing for quotation→ drawing with details of structure& function→ engineering drawing→mold drawing



# M

## 模具制作 Mold making

我司高级模具工程师制造，保证质量和交期  
Mold made by our senior mold engineer, ensuring quality and delivery



# I

## 生产注塑 Plastic injection

拥有国际先进的全自动注塑机  
We own international advanced fully automatic injection machines

# D

## 烫金印刷 Hot stamping and printing

拥有全自动的烫金，丝印等机器设备  
We own fully automatic hot stamping and silk screen machines



# A

## 装配包装 Assembly

训练有素的装配队伍，保证每个包装产品的美观精致  
Well trained packing team to ensure every piece of product is well and delicately packed.



# W

## 仓储运输 Warehousing & Shipping

仓储运输过程严格监控，确保产品安全、完整、快捷到达客户手中  
Warehousing and transportation process are strictly monitored to ensure products arrive at the customers safely, intactly and quickly.





# 4

## HARDWARE 硬件优势

**厂房设备** 现代化的厂房和顶级设备是高标准产品的根本保障，莱汇采用国际最先进的生产机器及检测设备，一流的中央空调洁净车间，生产环境达到国际标准。  
Workshop & Equipment modern plant and top-class equipment are the fundamental guarantee of high standard product. NICE PACKAGING adopts the internationally advanced manufacturing machine and testing equipments, first-class clean workshops with central air conditioning system, production environment has reached the international standard.

**生产制成** 严格按照计划和标准的生产制作流程进行生产和品控，确保出厂的每一件产品为优质合格产品。  
Production: manufacturing and quality control are strictly in accordance with the plan of standard production process to ensure each product is qualified.



## WHY US 为什么选择我们?

# 5

## 选对供应商 Selecting a Right Vendor

- Q** 供应商是否有适当的质量体系?  
Does the supplier have quality systems in place?
- A** 我们广州的厂房已通过ISO 9001:2008认证，我们拥有无尘生产车间。  
The Guangzhou plant has been awarded ISO 9001:2008 as well as dust-free workshop certificates.
- Q** 在这个行业里，你的竞争优势是什么?  
What is your competitive advantage in your industry?
- A** 我们的团队富有理想，激情和经验。我们重视品质和客户的评价。我们追求不断创新,客户至上，追求完美。  
Our team is full of ideal, passion and experience.  
We value the quality of our products and the comments from our customers.  
We are in persistent pursuit of continuous innovation, customer-orientation and perfectness.
- Q** 供应商能满足从材料采购到生产不同类型的化妆品包材及最后组装等方面全方位的需求吗?  
Can the supplier manage a full range of requirements from material sourcing to production of different kinds of cosmetic packaging & final assembly?
- A** 我们是一个一站式服务提供商,从概念到运输到本地和全球。  
We are a one stop service provider, from the concept development to local & global shipments.
- Q** 供应商是否遵守人权、健康与安全、控制有毒物质和环境保护的国际标准?  
Does the supplier adhere to international standards on human rights, health & safety, control of toxic materials, environmental protection?
- A** 我们已经实现了符合ROHS和实行符合SA8000社会责任国际标准的体系,正在实施ISO 9001:2008。  
We've already achieved system that is in compliance with ROHS and SA8000 social responsibility international standard. We are now implementing ISO 9001:2008.
- Q** 热心助人，善于沟通，知识渊博这3点是如何成为沟通的关键?  
How helpful, connectable and knowledgeable are the contact points?
- A** 我们建立了专门的沟通管理系统，以及一支在国际客服方面拥有平均7年经验的客服团队。  
We have built a dedicated management system and customer service team with an average of 7 years of experience in serving international customers.



# 6

## ASSEMBLY WORKSHOP 装配车间



缜密的生产计划管理  
科学规范的生产流程管理  
多道工序的严格品控  
国际模式的工厂内部管理及训练有素的员工 高效科学的运营管理团队  
专业规范的客户服务中心和个性化服务团队

meticulous producing planning management  
scientific and standardized producing process management  
multi-process of strict quality control  
international pattern of factory internal management and well-trained staff, efficient and scientifically operating management team  
Professional and standardized customer service center and individualized service team

### 1

IQC:接到仓库送货单通知后，核对SIP资料对来料进行检验。  
IQC: after receiving delivery note from the warehouse, check the SIP data and inspect incoming material.

### 2

IPQC:对生产前首件产品的质量依据SIP进行外观/尺寸/功能的检验，合格确认生产。生产过程每3H/巡检外观，尺寸/功能一班一次，并如实填写检验报表。

IPQC: inspect the appearance/size/function of the first article before producing according to the SIP quality standard, production only can be confirmed as long as the article is qualified. We check the appearance/size/function one shift every 3 hours and fill in the inspection forms according to the result.

### 3

OQC:所有包装OK后，再按AQL抽查，合格就可以出货，若不合格，则全面返工，返工后重新抽检直到大货合格后，方可出货。

OQC: when all the packing are ok, we do AQL selective inspection. The qualified will be arranged to be dispatched, otherwise they will be returned to rework. They can only be shipped until the sampling inspection of the mass production is okay.

Q&C  
品质监测

# 7





## 1 影像测量仪 Image measurement instrument

高解析度CCD彩色摄像机，连续高倍物镜，以2维测量为主，精密检测产品用卡尺测量不到的或难以检测的各类尺寸，以投影的方式测试出来。可用它高效检测各种形状复杂工件的轮廓尺寸和表面现状。  
CCD color camera with high resolution, which focus on constant high power objective and two dimensional measurement, will precisely measure all kind of size of products by way of projection that can not or difficultly be measured with callipers. It can be used to efficiently test overall dimentions and surface situation of complicated components in different shapes.



## 2 可程式恒温恒湿箱 Programmable constant temperature and humidity box

可程式恒温恒湿试验机具备模拟高温，低温，高低温交变，湿热等功能，对产品进行恒温恒湿测试，是目前众多生产和研发企业使用的重要方法，主要是检测产品在不同温湿度环境下的使用和储存性能，检测产品质量，提升产品品质。  
Programmable constant temperature and humidity testing machine has the function of simulated high temperature, low temperature, high and low temperature alternating, muggy, etc. To do the constant temperature and humidity test for products is an important method for many production and research and development enterprises. It is mainly to test products' use and storage performance in different temperature and humidity environment, test the quality of the products and improve product quality.



## 3 真空测漏箱 Vacuum drying oven

真空箱就是将箱内的真空抽出去，使箱内产生负压，检测产品的密封性能在负压的情况下是否会漏液，产品是否合格。  
真空干燥，主要是利用真空脱水，达到干燥的目的，可以检测在干燥的情况下再真空负压。  
CVacuum chamber which pumps vacuum out of chamber to make it nagative pressure, is used to check whether products will leak or not under negative pressure. Vacuum drying which dewateres with vacuum and make it dry, is used to test presure bearing of products in dry circumstance.



## 4 对色灯箱 Color Assessment Cabinet

设备是标准的对色环境，从而保证产品在试样，生产过程中颜色的控制及验货的颜色品质。  
The equipment is set with standard color-matching environment, to ensure color control during sampling and production and color quality when goods inspection.



## 5 数显式推、拉力仪 Digital display type push, pull instrument

产品组合的拉力测试，凡二个零部件组装之产品都涉及到拉力测试，测试拉力数据。  
推力测试，根据产品需要二者组装时要求做推力测试。测试推入力数据。  
Pulling force test product portfolio , all the products of two components assembled are related to the pulling force test, test the pulling force data.  
Thrust test, according to the needs of the products when the two assembled is requiring thrust test. Test push force data.



## 6 电子天平 Electronic scales

精密测量产品的单重，容量。及单个产品有关的称重。  
It is used to precisely measure weight and volume of products, as well as other relative weight of each goods.



## 7 盐雾测试机 Salt spray test machine

测试规定为各项金属产品及金属底材于电镀后、有机或无机涂装后等各项表面处理用之盐水喷雾耐触性试验。测试是否会生锈及表面电镀、涂装是否会脱落。  
Test for various metal products and metal substrate after electroplating, organic or inorganic coating and other surface treatment with salt spray resistance contact . To test whether the rust and surface electroplating, painting will fall off.

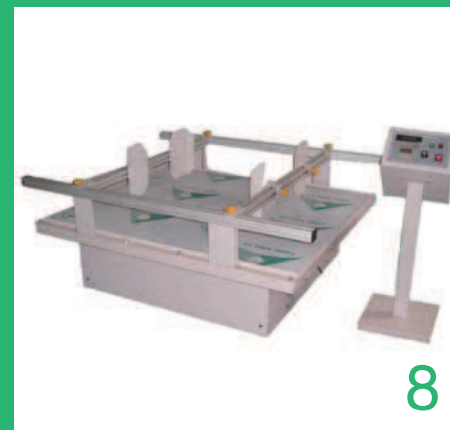

## 8 模拟运输振动试验机 Simulating transportation vibration testing machine

模拟产品包装之后测试在运输过程中因路途颠簸导致产品刮伤、碰伤。通过测试及早发现问题并有利于进一步改进产品的包装缺陷和功能。  
After packaging, it will be used to make simulation test to check if goods will be scratched or damaged by jolt transportation. Test will help find problems early so that further improvement will be made to avoid poor packaging.



## 9 数显高度尺 Digimatic heitht gages

测量产品的高度、厚度尺寸及异形产品的高度、厚度尺寸。  
It is used to measure height and thickness of products, as well as special-shaped products.



## 10 数显卡尺 Digital caliper

精密检测产品各零部件的尺寸。有效控制产品的质量，进一步控制及改进产品的质量稳定性。  
It is used to measure dimentions of all components of products. It will help efficiently control goods quality and further control and improve quality steadiness.

QUALITY  
DETECT  
品质检控

8



# 9

## RESPONSIBILITY 我们的责任

我们的第一责任是要对放心将产品交于我们生产的客户负责。

我们的产品必须保证高质量。

同时我们也必须不断地降低产品的成本以使客户获得最大利益。

我们接到的订单必须及时、安全并准确的完成。

Firstly, we are responsible for the customers who have confidence in us as well as our products.

We must guarantee that our products are high quality.

In the mean time, we must try our best to deduce the product cost and strive for the maximum benefit for our customers.

The orders received should be completed timely, safely and accurately.

我们的第二项职责是要对公司的员工负责。

必须让我们的员工对工作充满安全感。

薪酬福利必须保持公平、适当的原则，工作环境必须清洁安全。

每名合格的员工都有培训及晋升的机会，保证每个员工都能体现自己的价值。

Secondly, we are responsible for those who work for us.

Let our staff have sense of security while working.

In the aspect of salary and welfare, we insist to keep the fair and appropriate principle. The working environment must be clean and safe.

The qualified staff should be given the opportunity for training and promotion, ensuring that all of them can achieve their self-value.

我们的第三项职责是对我们的社会负责。

我们必须成为一个合格的全球企业公民，致力工作，并承担相应的税收。

我们必须珍惜并维护我们特有的资源。

Thirdly, we are responsible for the society.

We should try our best to be a qualified global citizen, devoting to our work, and affording the corresponding taxes.

We should treasure and maintain our unique resources.

我们坚决尽自己最大的努力履行以上义务。

We will do our best to fulfill the above obligations.



我们在香港和广州都拥有自己的生产设施，能够满足中国国内和国外化妆品行业对包装材料的要求。

We have built our own manufacturing facilities both in Hong Kong and Guangzhou to meet the special requirements of packaging materials for cosmetic industries at home and abroad.

# 10

WHERE ARE WE  
我们在哪里

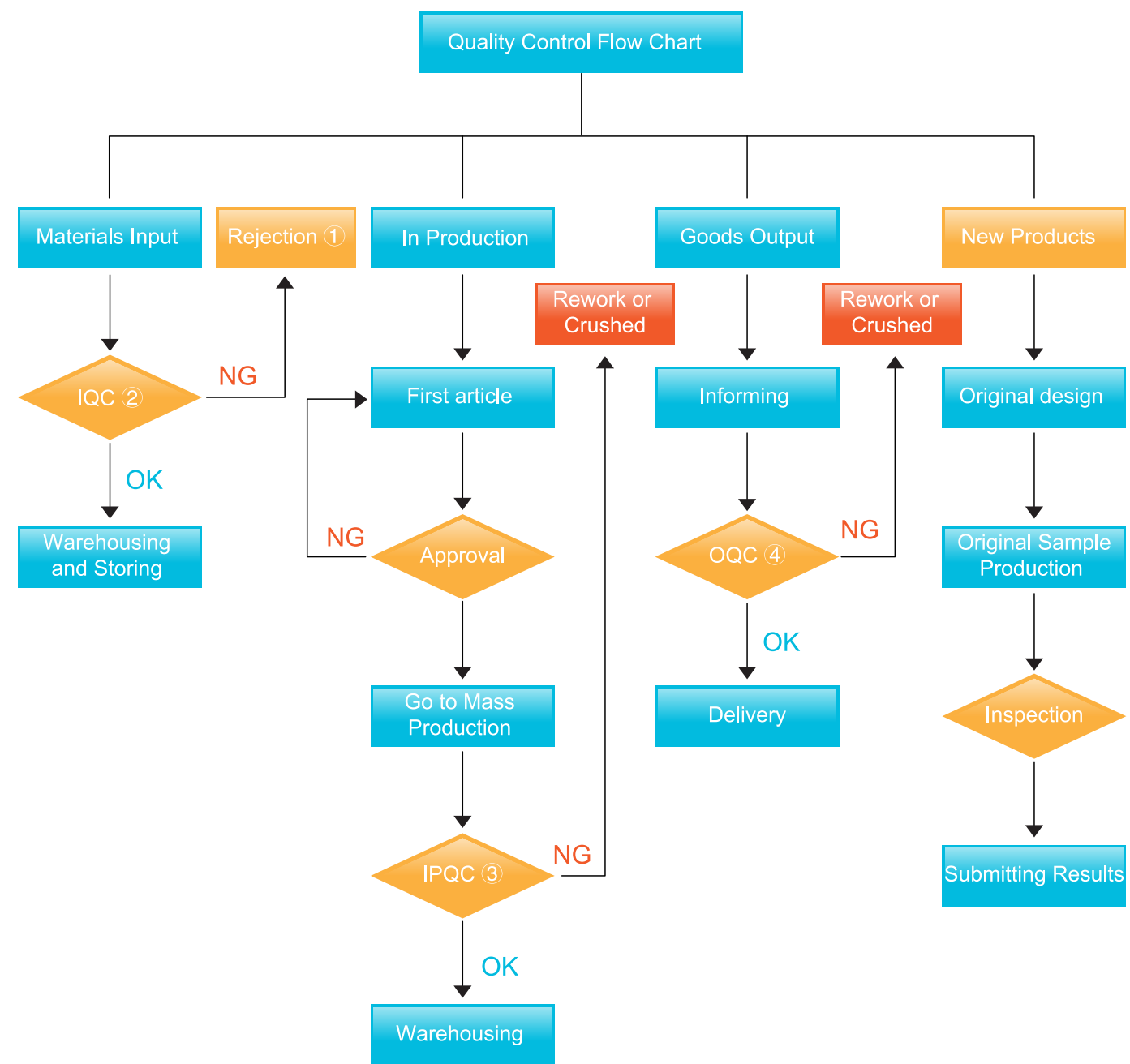

Remark:

① If the material is rejected, factory will send back all the material to supplier, requiring supplier rework or exchange all material until the material passed inspection.

② IQC: Incoming quality control

③ IPQC: In-line production quality control

④ OQC: Output quality control or Final quality control

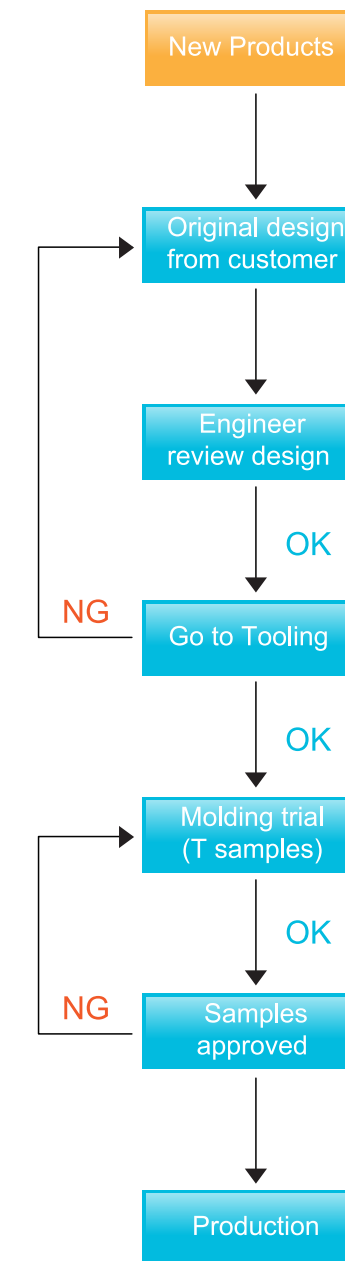

# 11

## QUALITY CONTROL FLOW CHART



C009

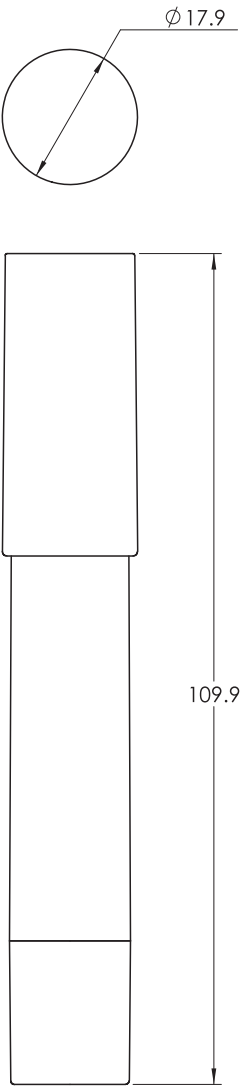

品 名	型 号	材 料	容 量
NAME	MODEL NO.	MATERIAL	CAPACITY
口红笔 Lip Stick	C009	笔上盖 Cap - K胶	3.3g
		笔身 Body - ABS	
		珠仔 Cup - POM	
		螺纹套 Sprial - PP	

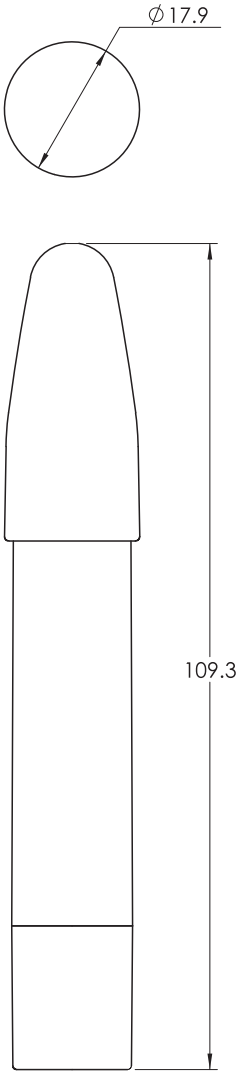

品 名	型 号	材 料	容 量
NAME	MODEL NO.	MATERIAL	CAPACITY
唇彩管 Lip Gloss case	C009A	盖 Cap - ABS	3.3g
		瓶身 Bottle - PCTG	
		刷杆 Stem - POM	
		内塞 Wiper - LDPE	



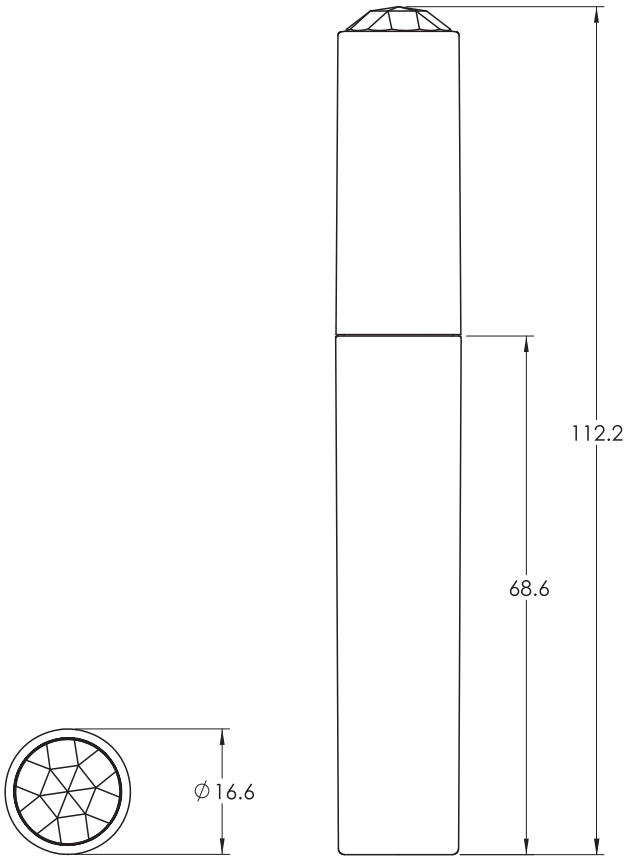

品 名	型 号	材 料	容 量
NAME	MODEL NO.	MATERIAL	CAPACITY
唇彩管 Lip Gloss case	C011	盖 Cap - ABS	4.25ml
		瓶身 Bottle - PCTG	
		刷杆 Stem - POM	
		内塞 Wiper - LDPE	

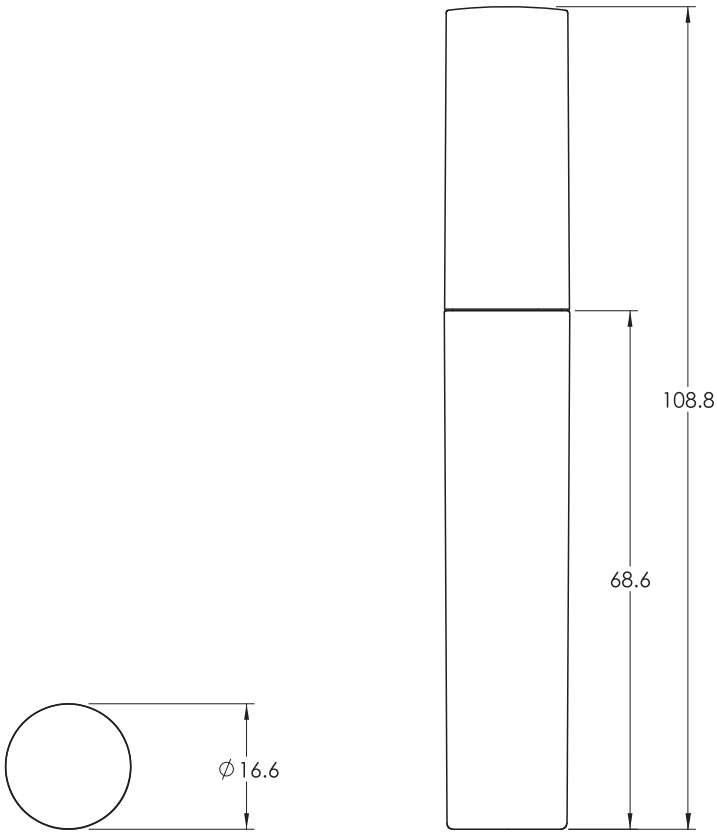

品 名	型 号	材 料	容 量
NAME	MODEL NO.	MATERIAL	CAPACITY
唇彩管 Lip Gloss case	C011A	盖 Cap - ABS	4.25ml
		瓶身 Bottle - PCTG	
		刷杆 Stem - POM	
		内塞 Wiper - LDPE	



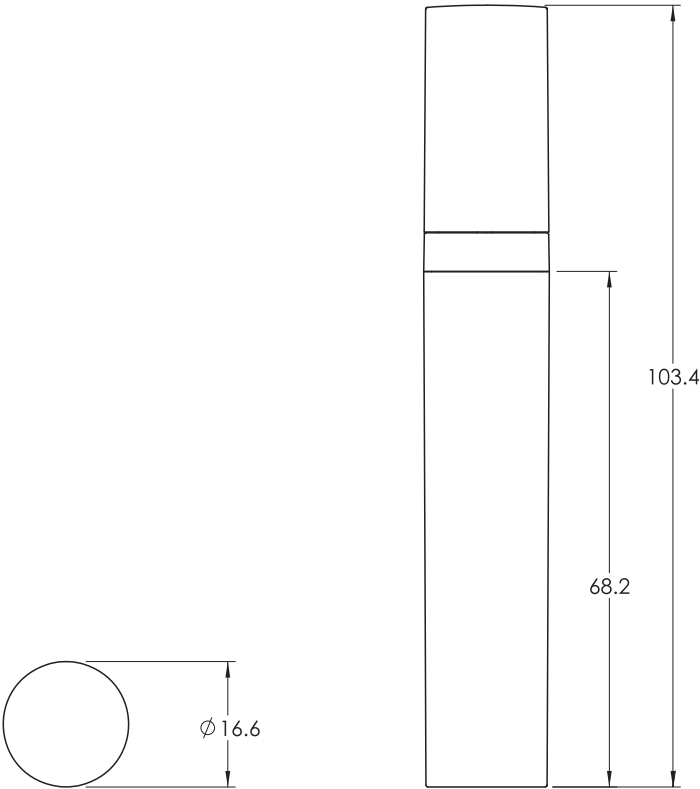

品 名	型 号	材 料	容 量
NAME	MODEL NO.	MATERIAL	CAPACITY
唇彩管 Lip Gloss case	C012	盖 Cap - ABS	6ml
		瓶身 Bottle - PCTG	
		刷杆 Stem - POM	
		内塞 Wiper - LDPE	
		中套 Middle Ring - ABS	

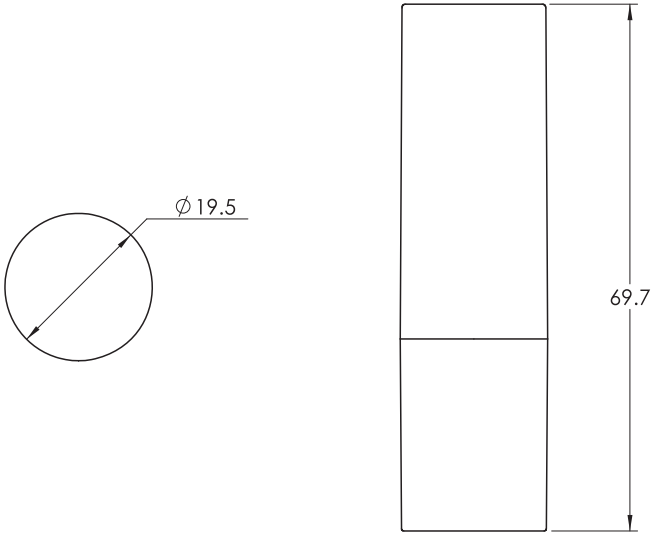

品 名	型 号	材 料	容 量
NAME	MODEL NO.	MATERIAL	CAPACITY
口红管 Lip Stick	C013	盖 Cap - ABS	3.5g
		底 Base - ABS	
		珠子 Cup - POM	
		叉仔 Inner Body - HIPS	
		螺 Sprial - HIPS	



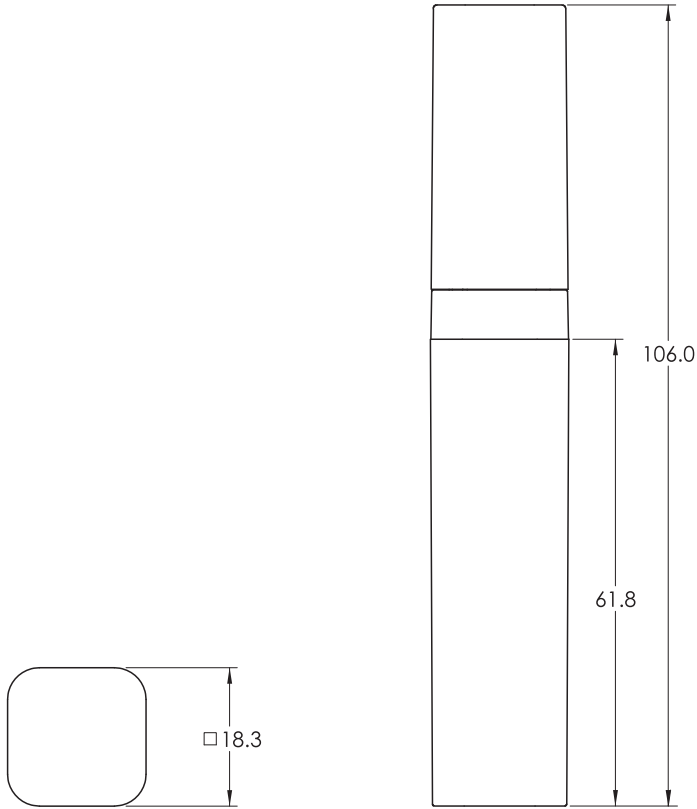

品 名	型 号	材 料	容 量
NAME	MODEL NO.	MATERIAL	CAPACITY
唇彩管 Lip Gloss case	C015	盖 Cap - ABS+AS	6.5ml
		瓶身 Bottle - PCTG	
		刷杆 Stem - POM	
		内塞 Wiper - LDPE	
		中套 Middle Ring - ABS	



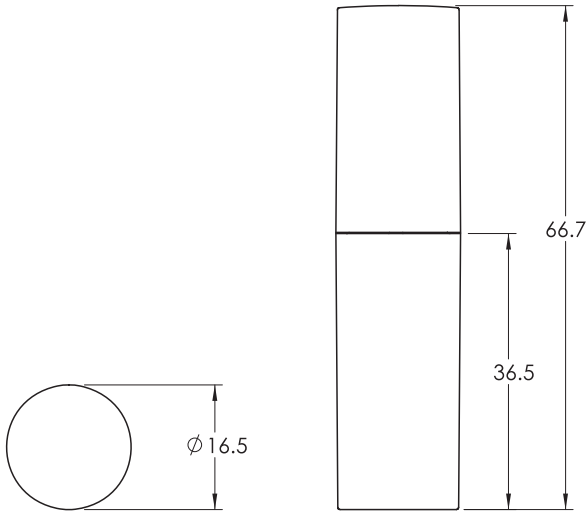

品 名	型 号	材 料	容 量
NAME	MODEL NO.	MATERIAL	CAPACITY
迷你唇彩管 Mini Lip Gloss case	C016	盖 Cap - ABS	1.8ml
		瓶身 Bottle - PCTG	
		刷杆 Stem - POM	
		内塞 Wiper - LDPE	

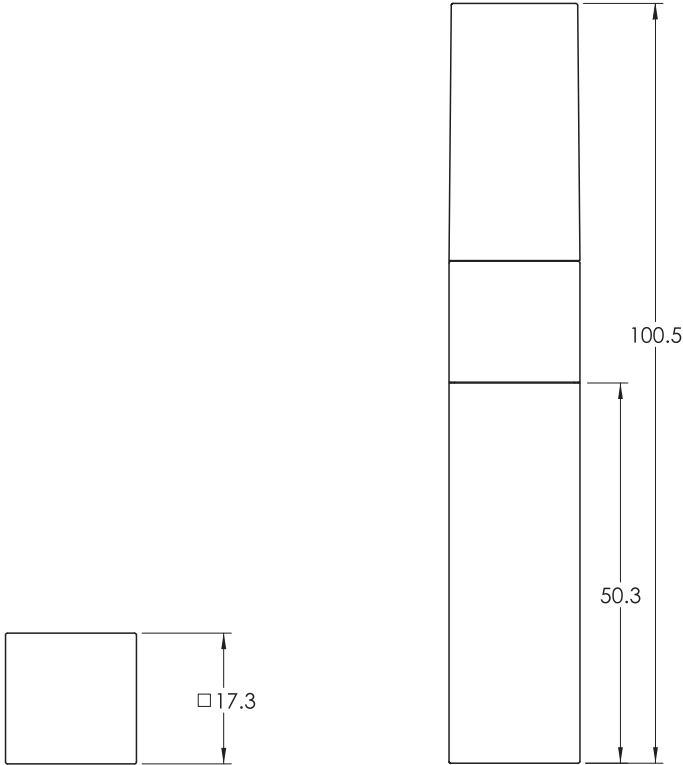

品 名	型 号	材 料	容 量
NAME	MODEL NO.	MATERIAL	CAPACITY
唇彩管 Lip Gloss Case	C018	盖 Cap - ABS	7.5ml
		瓶身 Bottle - PCTG	
		刷杆 Stem - POM	
		内塞 Wiper - LDPE	
		中套 Middle Ring - ABS	



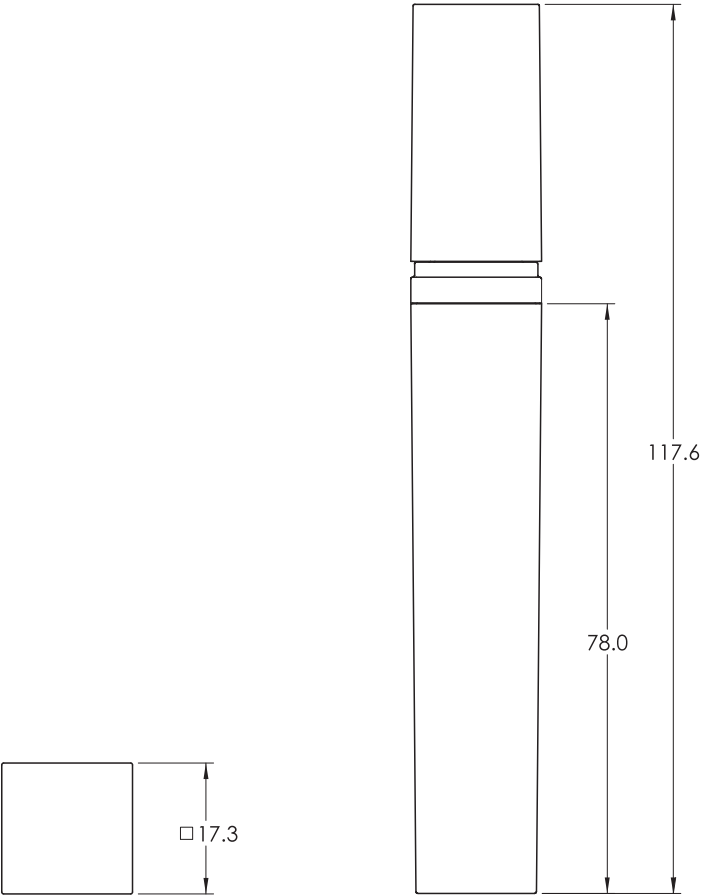

品 名	型 号	材 料	容 量
NAME	MODEL NO.	MATERIAL	CAPACITY
唇彩管 Lip Gloss Case	C019	盖 Cap - ABS	7.5ml
		瓶身 Bottle - PCTG	
		刷杆 Stem - POM	
		内塞 Wiper - LDPE	
		中套 Middle Ring - ABS	

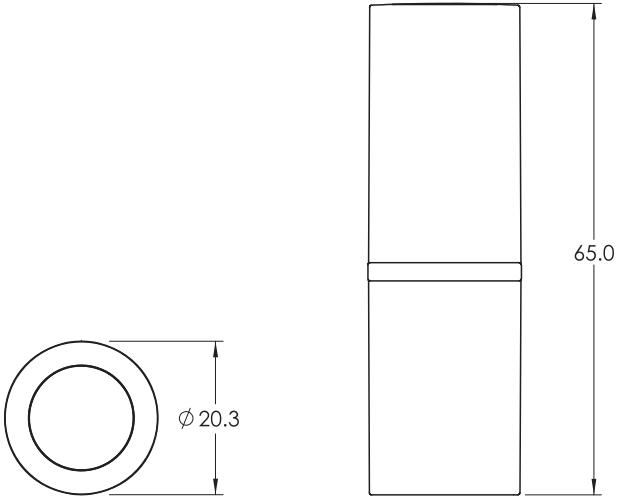

品 名	型 号	材 料	容 量
NAME	MODEL NO.	MATERIAL	CAPACITY
口红管 Lip Stick	C023	盖 Cap - ABS	3.5g
		底 Base - ABS	
		珠子 Cup - POM	
		叉仔 Inner Body - HIPS	
		螺 Sprial - HIPS	



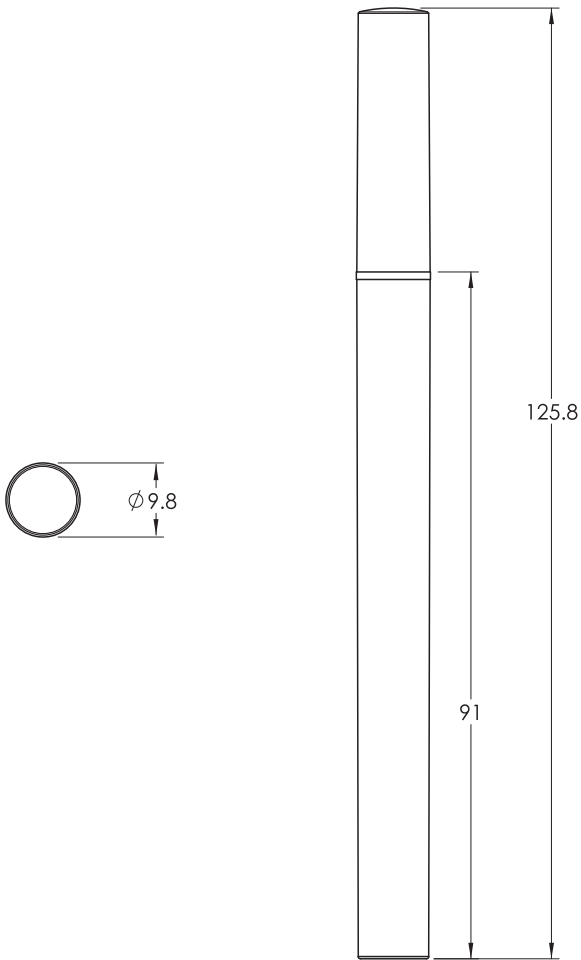

品 名	型 号	材 料	容 量
NAME	MODEL NO.	MATERIAL	CAPACITY
眼线笔 Eyeliner Pencil	C024	上盖Top Cap - PP	/
		气密盖 Airtight Cap - PP	
		瓶身 Body - PP	
		内胆 Inner Body - PP	
		底塞 Bottom Stuff - PP	
		排气阀 Vent Valve - POM	
		毛套 Brush Sleeve - PP	

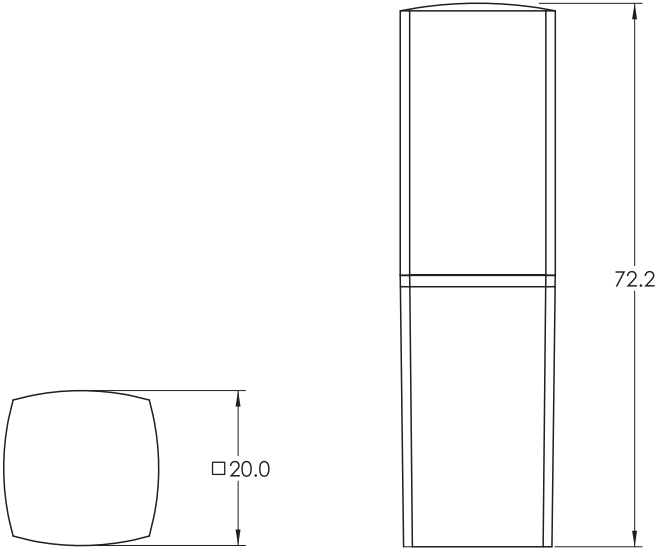

品 名	型 号	材 料	容 量
NAME	MODEL NO.	MATERIAL	CAPACITY
口红管 Lip Stick	C029	盖 Cap - ABS	3.5g
		底 Base - ABS	
		珠仔 Cup - POM	
		叉仔 Inner Body - HIPS	
		螺 Sprial - HIPS	



C001A

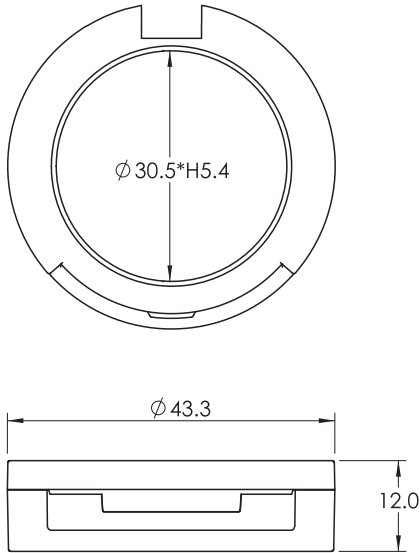

品 名	型 号	材 料	容 量
NAME	MODEL NO.	MATERIAL	CAPACITY
粉盒 Eyeshadow Case	C001A	盖 Cover - AS	2.7g
		底 Base - AS/ABS	

C002A

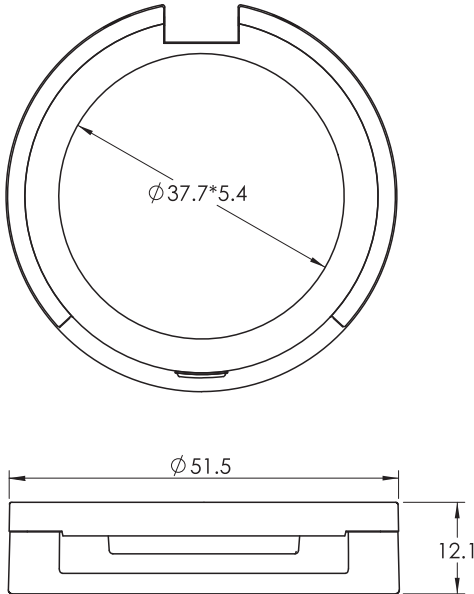

品 名	型 号	材 料	容 量
NAME	MODEL NO.	MATERIAL	CAPACITY
粉盒 Eyeshadow Case	C002A	盖 Cover - AS	4.0g
		底 Base - AS/ABS	



C003A

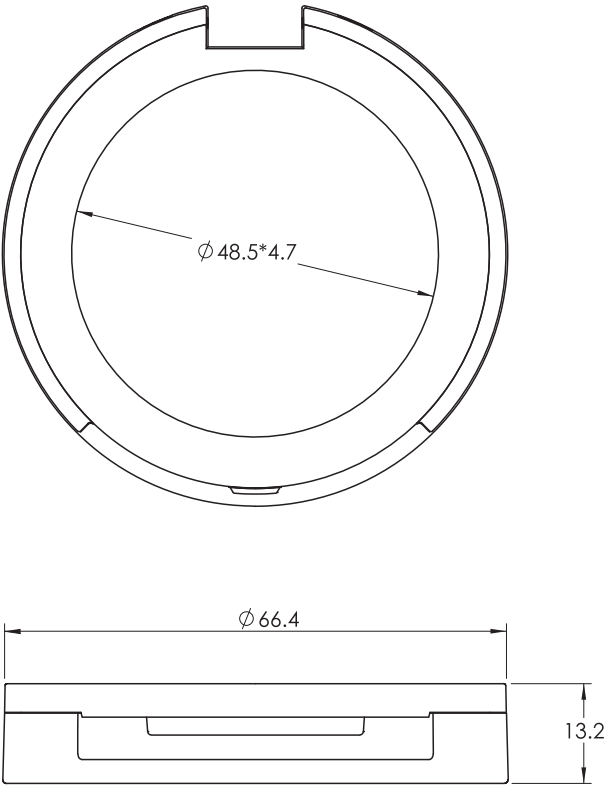

品 名	型 号	材 料	容 量
NAME	MODEL NO.	MATERIAL	CAPACITY
粉盒 Eyeshadow Case	C003A	盖 Cover - AS	7.2g
		底 Base - AS/ABS	

C004A

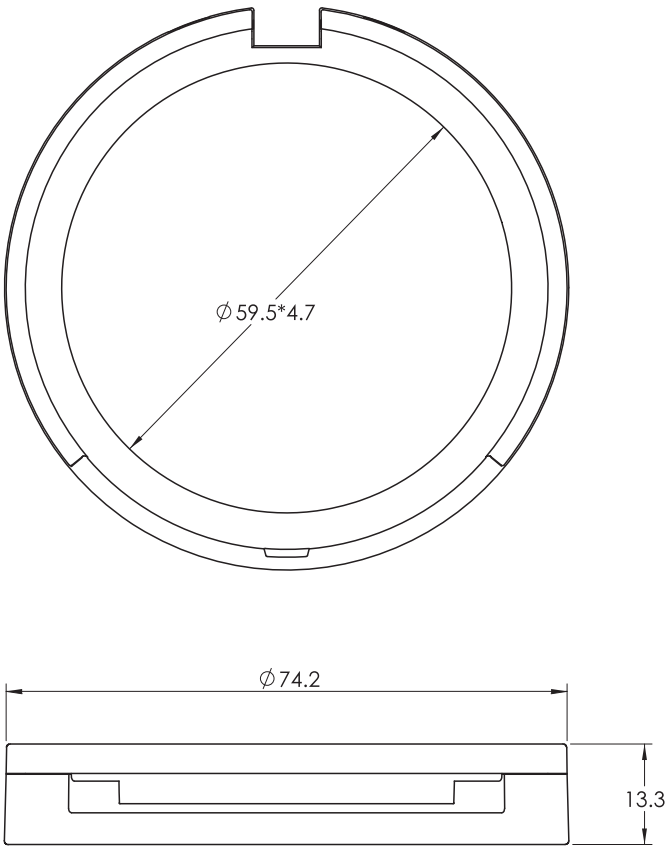

品 名	型 号	材 料	容 量
NAME	MODEL NO.	MATERIAL	CAPACITY
粉盒 Eyeshadow Case	C004A	盖 Cover - AS	10.8g
		底 Base - AS/ABS	



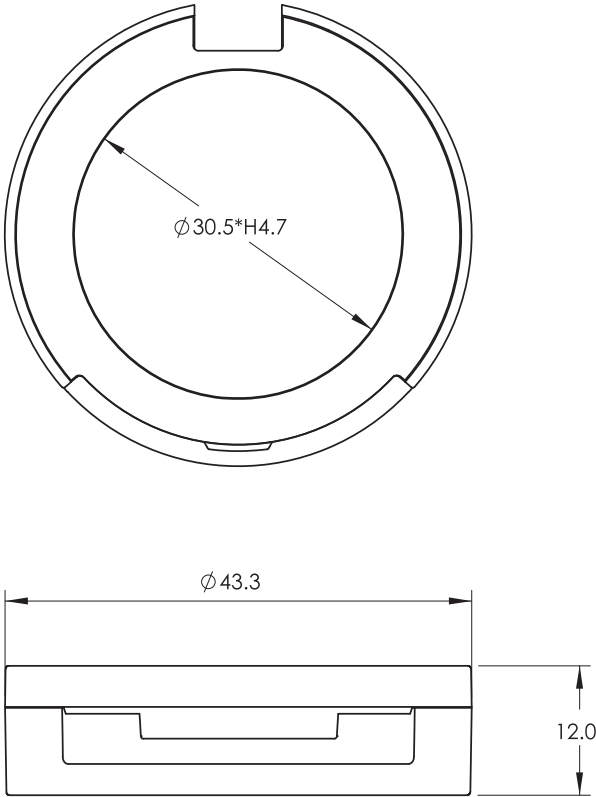

品 名	型 号	材 料	容 量
NAME	MODEL NO.	MATERIAL	CAPACITY
粉盒 Eyeshadow Compact	C001	底 Base - ABS	2.6g
		盖 Cover - ABS	
		内格 Platform - ABS	

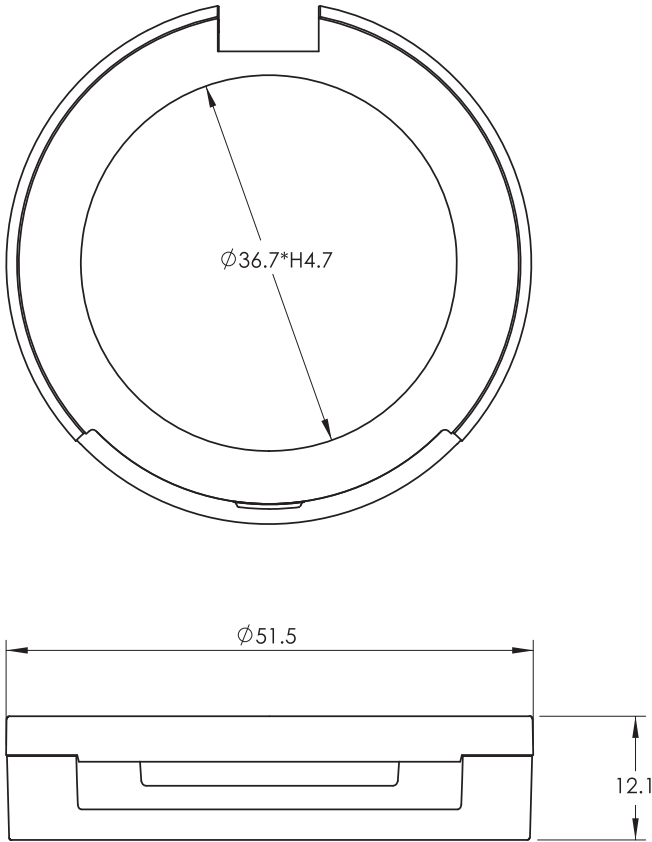

品 名	型 号	材 料	容 量
NAME	MODEL NO.	MATERIAL	CAPACITY
粉盒 Eyeshadow Compact	C002	底 Base - ABS	3.8g
		盖 Cover - ABS	
		内格 Platform - ABS	

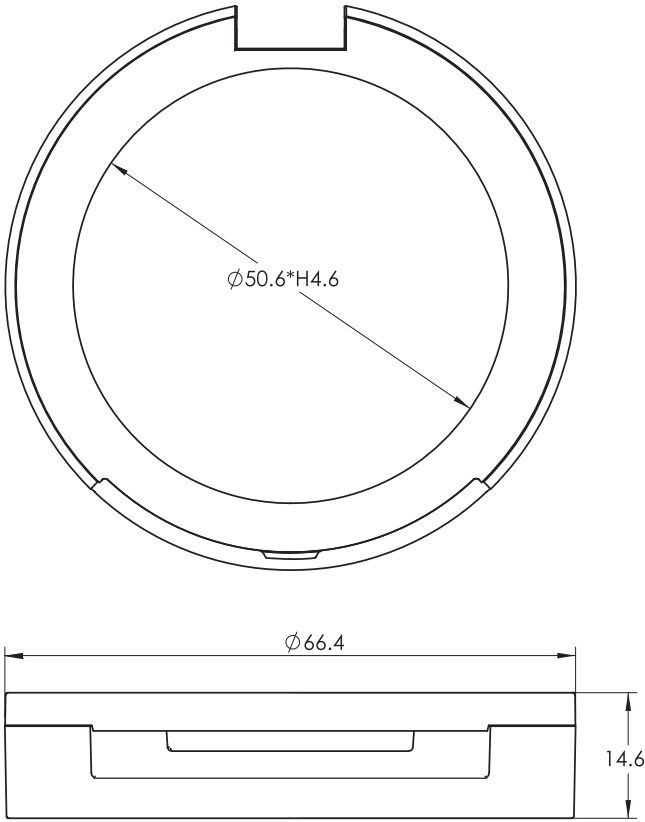

品 名	型 号	材 料	容 量
NAME	MODEL NO.	MATERIAL	CAPACITY
粉盒 Blush Compact	C003	底 Base - ABS	7.4g
		盖 Cover - ABS	
		内格 Platform - ABS	



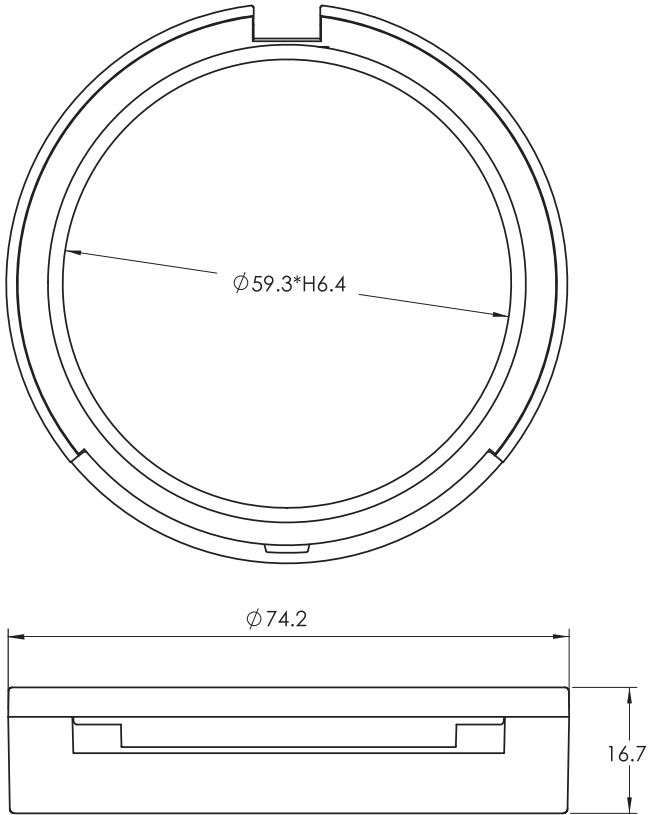

品 名	型 号	材 料	容 量
NAME	MODEL NO.	MATERIAL	CAPACITY
粉盒 Pressed Powder Compact	C004	底 Base - ABS	14.8g
		盖 Cover - ABS	
		内格 Platform - ABS	

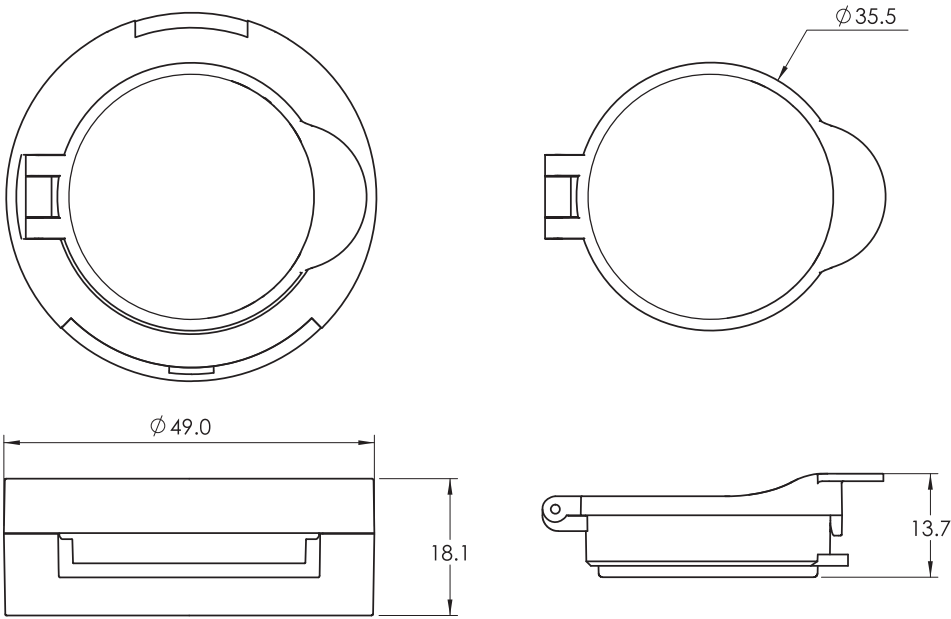

品 名	型 号	材 料	容 量
NAME	MODEL NO.	MATERIAL	CAPACITY
粉盒 Eyeshadow Airtight Compact	C005	底 Base - ABS	3.3g
		盖 Cover - ABS	
		内格 Platform - ABS	
		内瓶 Inner Case - PP	
		内瓶盖 Inner Cover - PP	

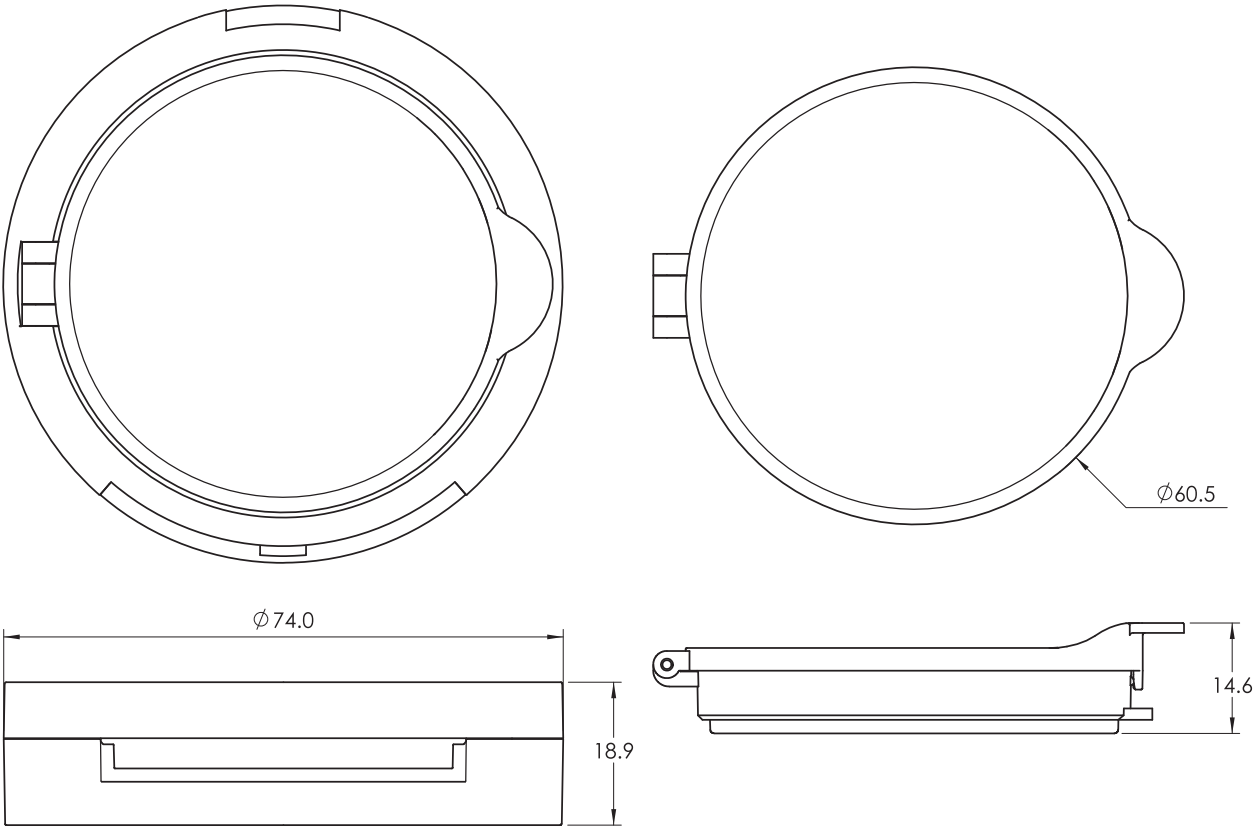

品 名	型 号	材 料	容 量
NAME	MODEL NO.	MATERIAL	CAPACITY
粉盒 Large Airtight Compact	C006	底 Base - ABS	12g
		盖 Cover - ABS	
		内格 Platform - ABS	
		内瓶 Inner Case - PP	
		内瓶盖 Inner Cover - PP	



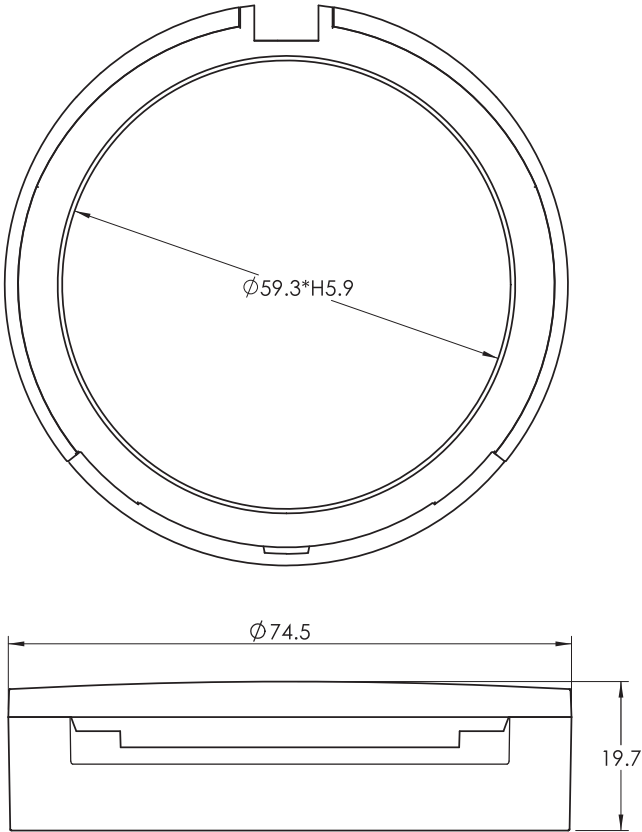

品 名	型 号	材 料	容 量
NAME	MODEL NO.	MATERIAL	CAPACITY
粉盒 Pure Wet/Dry Compact	C007	底 Base - ABS	13.5g
		盖 Cover - ABS	
		内格 Platform - ABS	

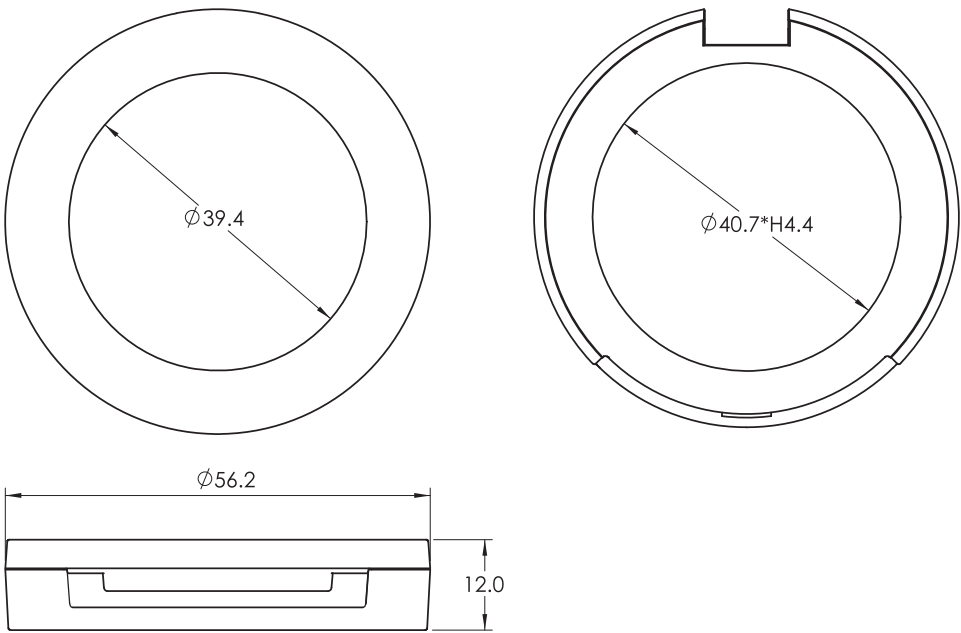

品 名	型 号	材 料	容 量
NAME	MODEL NO.	MATERIAL	CAPACITY
粉盒 Blush Compact	C008	底 Base - ABS	4.4g
		盖 Cover - ABS	
		内格 Platform - ABS	
		透明片 Window - SAN	

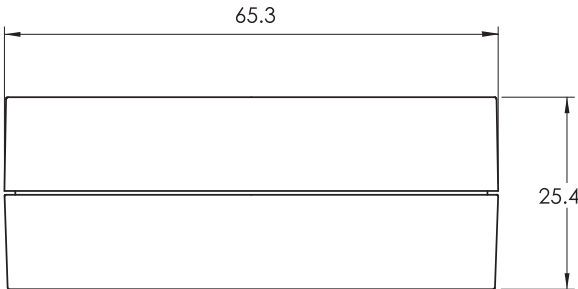

品 名	型 号	材 料	容 量
NAME	MODEL NO.	MATERIAL	CAPACITY
粉瓶 Loose Powder Compact	C010	盖 Cover - ABS	17g
		底 Base - SAN/PMMA	
		内塞 Dial - PP	
		拨盘 Sifter - PP	



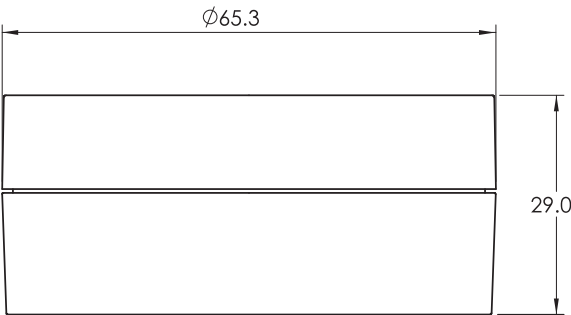

品 名	型 号	材 料	容 量
NAME	MODEL NO.	MATERIAL	CAPACITY
粉瓶 Loose Powder Compact	C010A	盖 Cover - ABS	26.5g
		底 Base - SAN/PMMA	
		内塞 Dial - PP	
		拨盘 Sifter - PP	

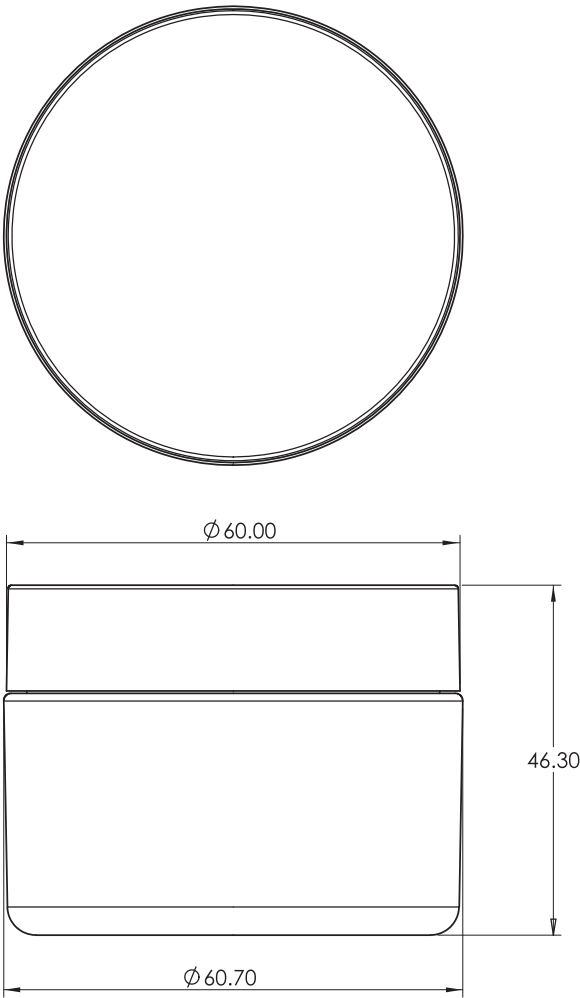

品 名	型 号	材 料	容 量
NAME	MODEL NO.	MATERIAL	CAPACITY
膏霜瓶 Cream Jar	C030	盖 Cover - ABS	50g
		底 Base - PCTG	

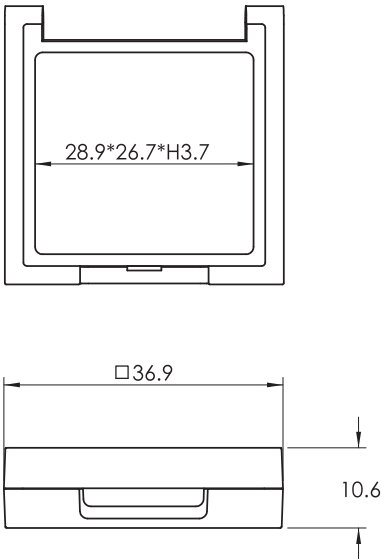

品 名	型 号	材 料	容 量
NAME	MODEL NO.	MATERIAL	CAPACITY
方形小粉盒 Square Compact	C025	盖 Cover - PMMA	2.1g
		底 Base - PMMA	



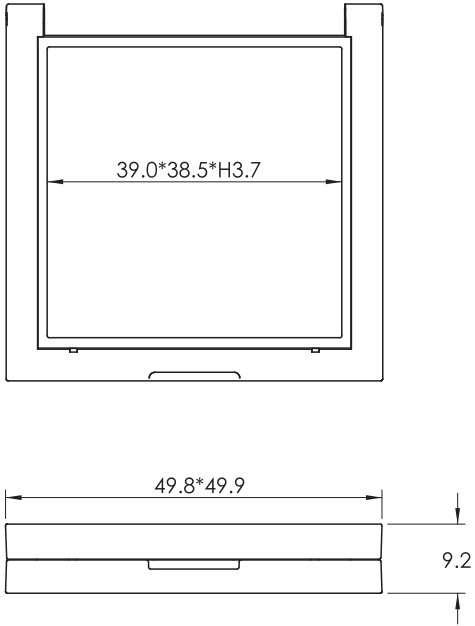

品 名	型 号	材 料	容 量
NAME	MODEL NO.	MATERIAL	CAPACITY
方形中粉盒 Square Compact	C026	盖 Cover - PMMA	4.0g
		底 Base - PMMA	

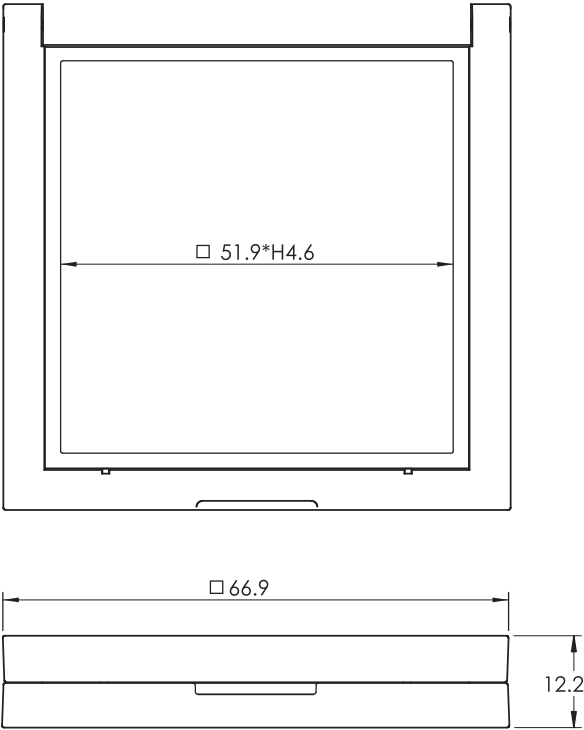

品 名	型 号	材 料	容 量
NAME	MODEL NO.	MATERIAL	CAPACITY
方形大粉盒 Square Compact	C027	盖 Cover - PMMA	9.8g
		底 Base - PMMA	

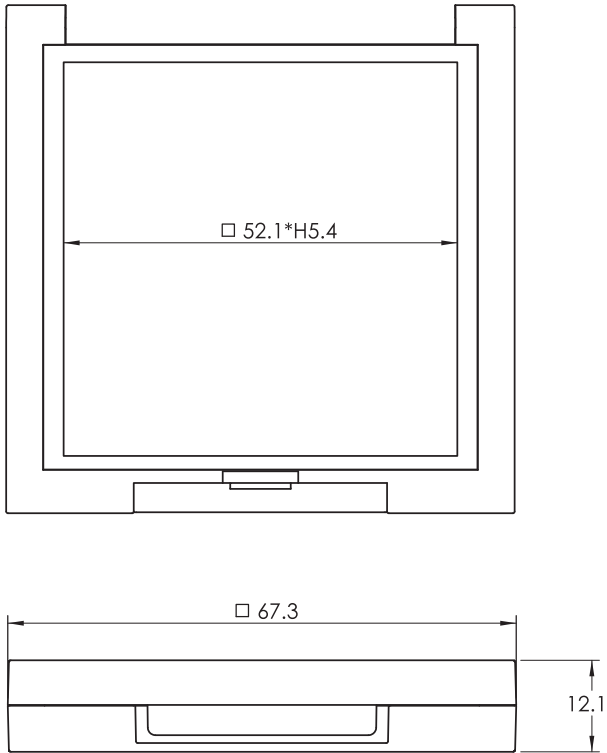

品 名	型 号	材 料	容 量
NAME	MODEL NO.	MATERIAL	CAPACITY
方形大粉盒A Square Compact	C028	盖 Cover - AS	11.8g
		底 Base - AS	



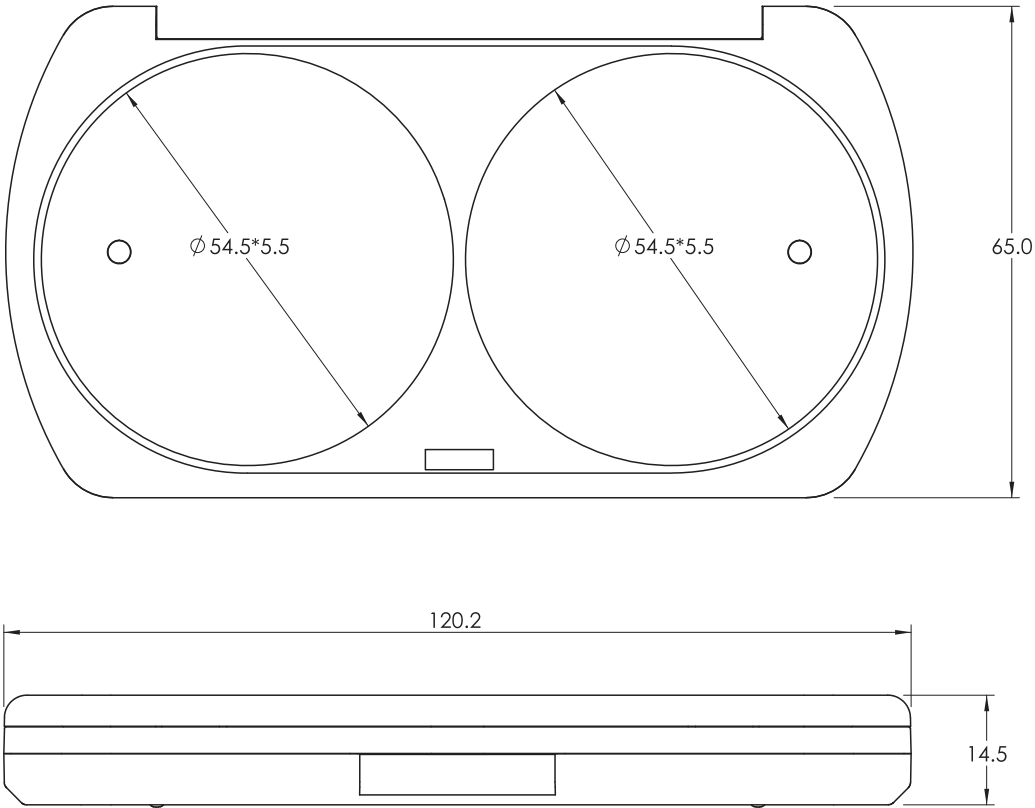

品 名	型 号	材 料	容 量
NAME	MODEL NO.	MATERIAL	CAPACITY
粉盒 Compact	C020	底 Base - ABS	10.5g
		盖 Cover - ABS	
		内格 Platform - ABS	
		按扣 Button - ABS	

## Attentions

### 注意事项

1. 根据内容物的使用条件，容器有可能发生变化，使用时请务必充分实验。
2. 品名的数字和目测的大致容量有一定的差异范围，有印刷、着色、发泡性内容物、比重等条件可能会使内容物有变化。因此，请做好样品测试。
3. 内容物、瓶子的尺寸，重量都是我们公司的既制色（加饰前）的规格数字，有可能和实测值不一样。
4. 请注意，由于材质、形状、容量的原因，产品在落下的时候，瓶子有可能会破损、盖子有可能会脱落。
5. 我们可以结合实际的情况，有可能进行规格变更。坚决拒绝容器设计的擅自复制、转载。

- 1.Changes over time in shape etc may occur depending on contents conditions of use etc please conduct sufficient testing.
- 2.Figures referring to names of products indicate standard volumes but there may be slight variations in addition volume may vary depending on printing coloring contents of packaging and weight etc please check by carrying out filling tests etc.
- 3.The table above showing standard weights may vary slightly from product to product.
- 4.Some specifications may be changed for the sake of convenience.
- 5.Unauthorized reproduction or reprinting of this design is strictly forbidden.



广州莱汇塑料包装有限公司  
NICE PACKAGING LIMITED  
[www.nicepack.com.hk](http://www.nicepack.com.hk)

MAIN LAND		HONG KONG	
Add	广州市科学城光谱西路69号TCL文化产业园 TCL Cultural Industrial Park,GuangPu West Road No.69,Science City,Hi-Tech Industrial Development Zone.Guangzhou 510663,P.R.China	Add	香港湾仔告士打道50号马来西亚大厦10楼02室 Room1002,1o/F Malaysia Building,50 Gloucester Road,Wan Chai HK
Direct Tel	+86 20 61038989	Direct Tel	+852-25788018
Fax	+86 20 61038867	Fax	+852-25663369
Email	infolaihui@tcl.com	Email	infolaihui@tcl.com
Web	<a href="http://www.nicepack.com.hk">www.nicepack.com.hk</a>	Web	<a href="http://www.nicepack.com.hk">www.nicepack.com.hk</a>